

### **STEP 1:**

Locate cage nut as shown on back side of rail.

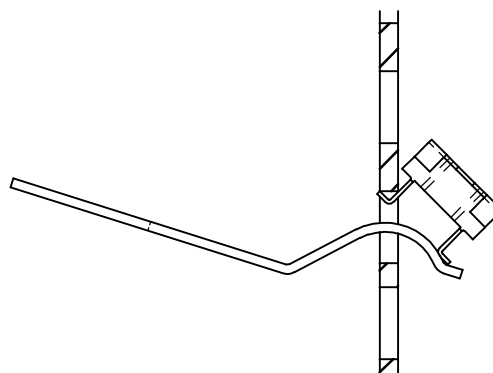

### **STEP 2:**

Insert through hole and hook onto bottom lip of cage nut.

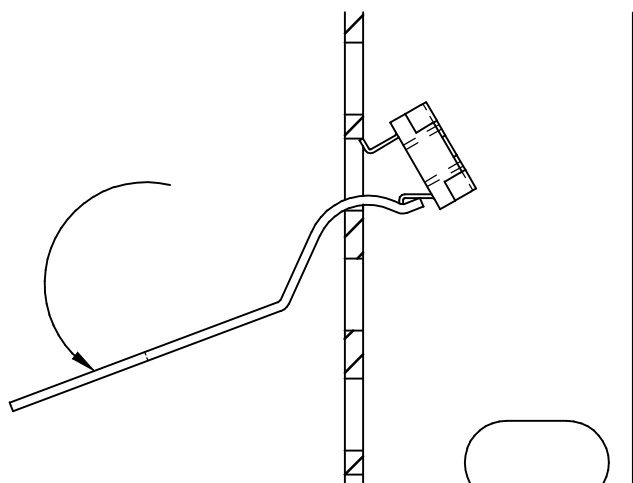

### **STEP 3:**

Rotate the cagenut tool down.

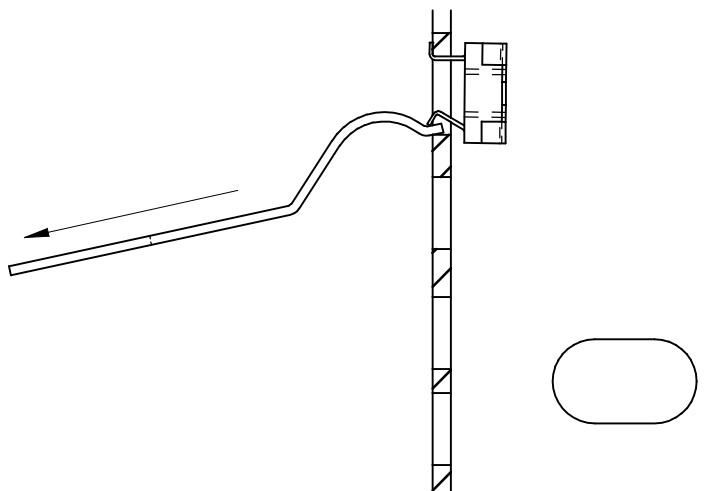

### **STEP 4:**

As you rotate down pull the tool back through the hole.

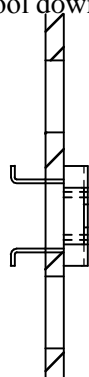

Cage nut fully positioned

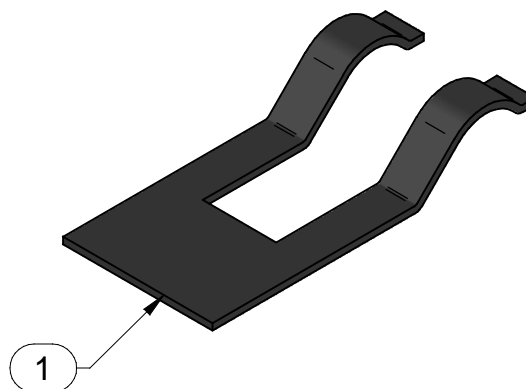

PARTS LIST		
ITEM No.	DESCRIPTION	QTY
1	CAGE NUT INSERTION TOOL	1



**SERVERRACK.COM**  
CUSTOMER FOCUSED SERVER RACKS  
POWERED BY RACKMOUNT SOLUTIONS, INC